

MALDIVES LAND SURVEY AUTHORITY

MINISTRY OF HOUSING AND INFRASTRUCTURE
Office (PABX): +(960) 3004300, Fax: +(960) 3004254
Email: survey@housing.gov.mv
Web: www.surveyofmaldives.gov.mv,
Ameenee Magu, Maafannu, Male', 20392, Maldives.



CONTROL POINT DETAILS	Station Number	PSM 5827
Coordinate Information		
Geodetic	Grid	
WGS 84	UTM Zone 43	
Lat: 5°14'08.12490"N	E: 293723.413 m	
Long: 73°08'19.87415"E	N: 579011.975 m	
Ellp Height: -106.448	Orth Height: +1.296m	
Island Name: DHIGUDHEFARU (LD0076)	Date: 16 FEBURUARY 2021	

Monument description & method of survey:

- Monument Type A as in Technical Brief
- Stainless steel plate fixed to concrete by Four bolts
- Horizontal coordinates fixed by GNSS Static survey.
- Elevation reduced relative to ellipsoid height difference , reference to PSM 5829 which was corrected to Meanwater level by tide prediction table (Hulhule)
- **PSM 5827 is 50mm above ground Level**

General site condition & access:

- Easily accessible area with wide angle of sky visibility
- Located in North side of the island.
- The island has no infrastructure build , only vegetation

Owner: Dhigudhefaru Investments Pvt Ltd.

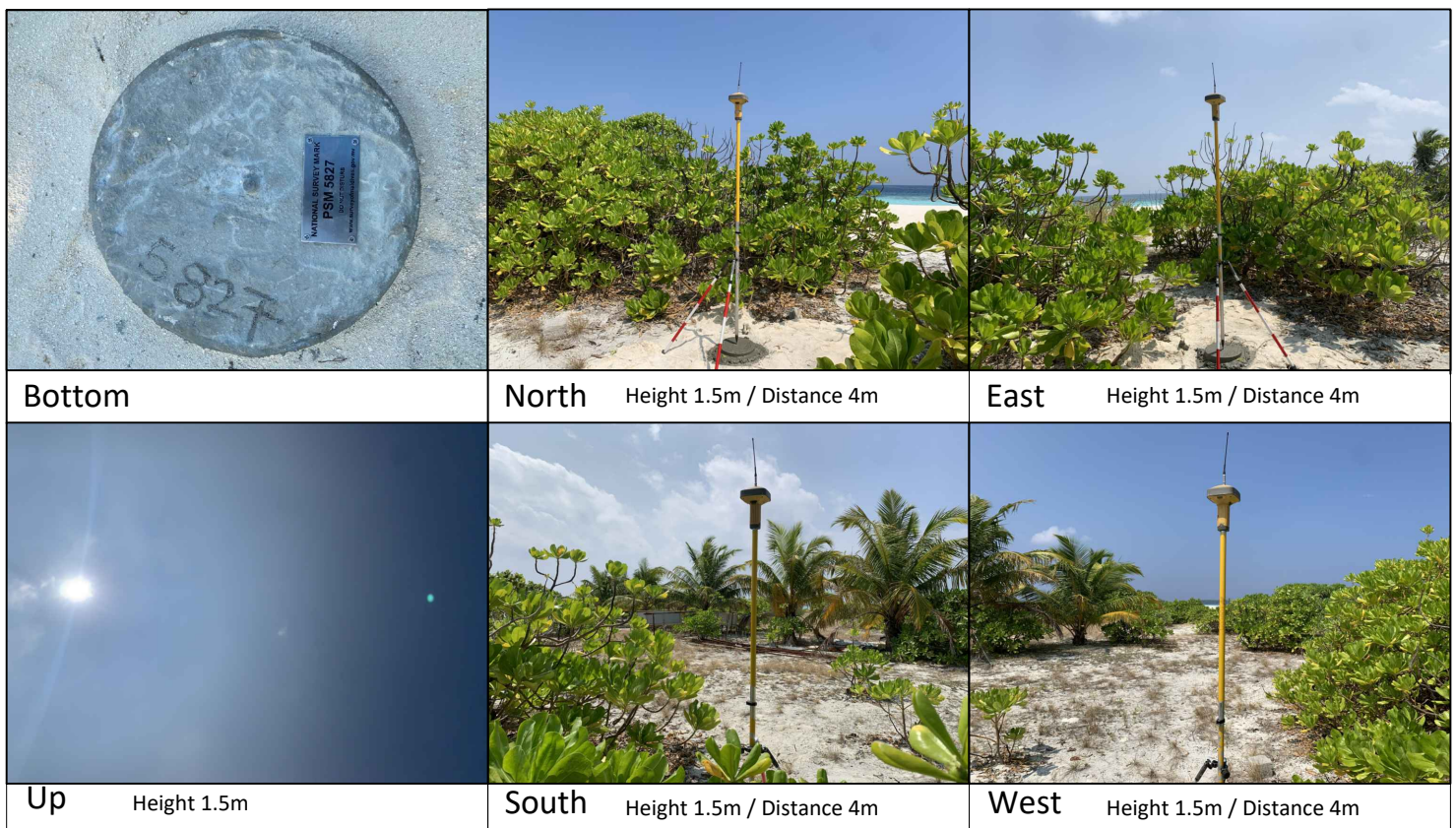

SITE INFORMATION

Station Number

P	S	M	5	8	2	7
---	---	---	---	---	---	---

Station Horizon Mask

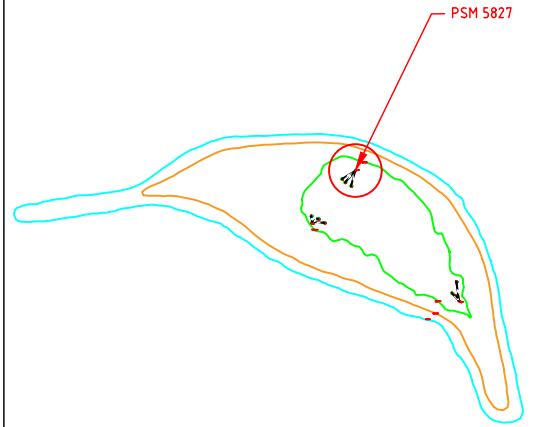
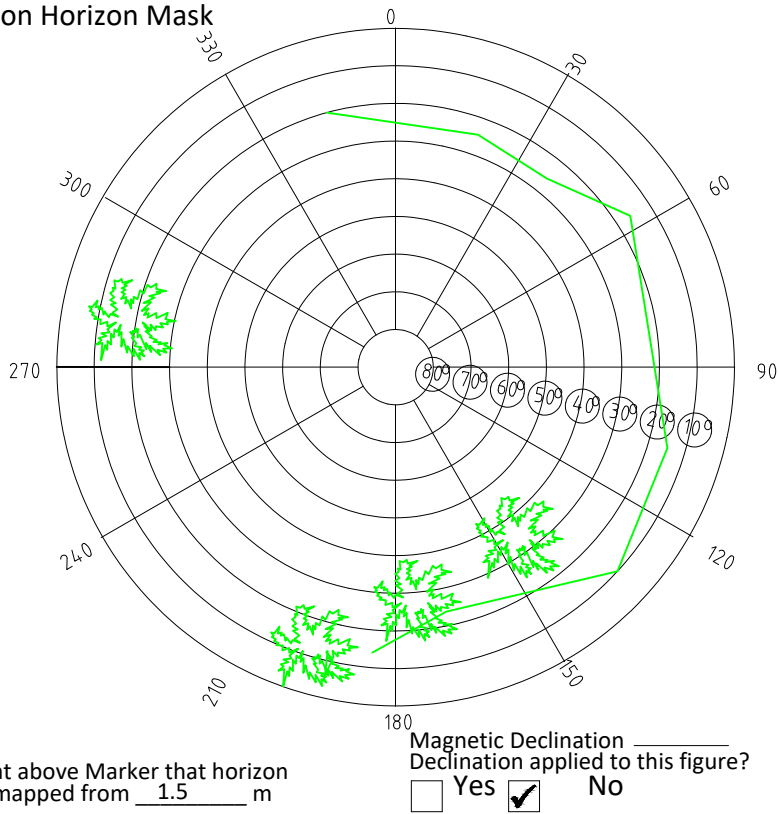

Vegetation line

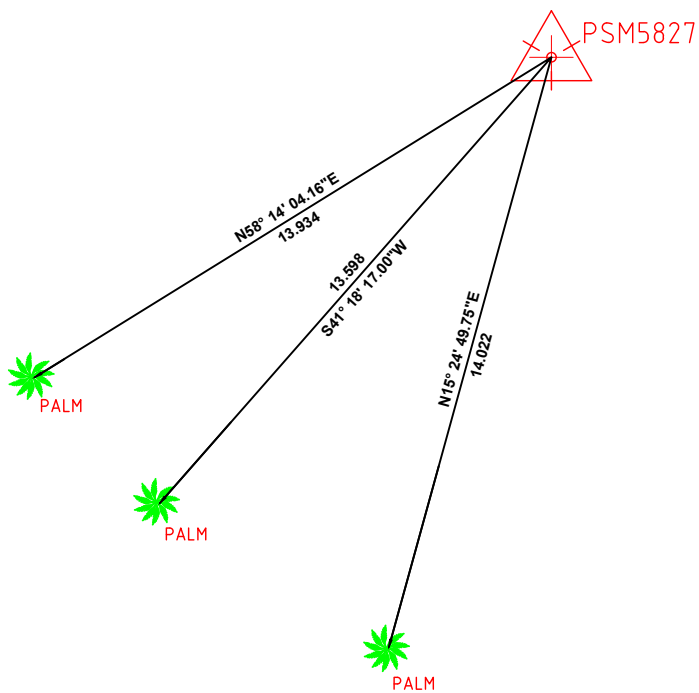

Sketched by: Abulho

Scale: Not to Scale

Date: 16 FEBURARY 2021

MALDIVES LAND SURVEY AUTHORITY

MINISTRY OF HOUSING AND INFRASTRUCTURE
 Office (PABX): +(960) 3004300, Fax: +(960) 3004254
 Email: survey@housing.gov.mv
 Web: www.surveyofmaldives.gov.mv,
 Ameenee Magu, Maafannu, Male', 20392, Maldives.



CONTROL POINT DETAILS	Station Number	PSM 5828
Coordinate Information		
Geodetic	Grid	
WGS 84	UTM Zone 43	
Lat: 5°14'06.65571"N	E:	293685.462 m
Long: 73°08'18.64625"E	N:	578966.952 m
Ellp Height: -106.185	Orth Height:	+1.559m
Island Name: DHIGUDHEFARU (LD0076)	Date:	16 FEBURUARY 2021

Monument description & method of survey:

- Monument Type A as in Technical Brief
- Stainless steel plate fixed to concrete by Four bolts
- Horizontal coordinates fixed by GNSS Static survey.
- Elevation reduced relative to ellipsoid height difference reference to PSM 5829 which was corrected to Meanwater level by tide prediction table.
- **PSM 5828 is 150mm Above ground Level**

General site condition & access:

- Easily accessible area with wide angle of sky visibility
- Located in West side of the island
- The island has no infrastructure build , only vegetation

Owner: Dhigudhefaru Investments Pvt Ltd.

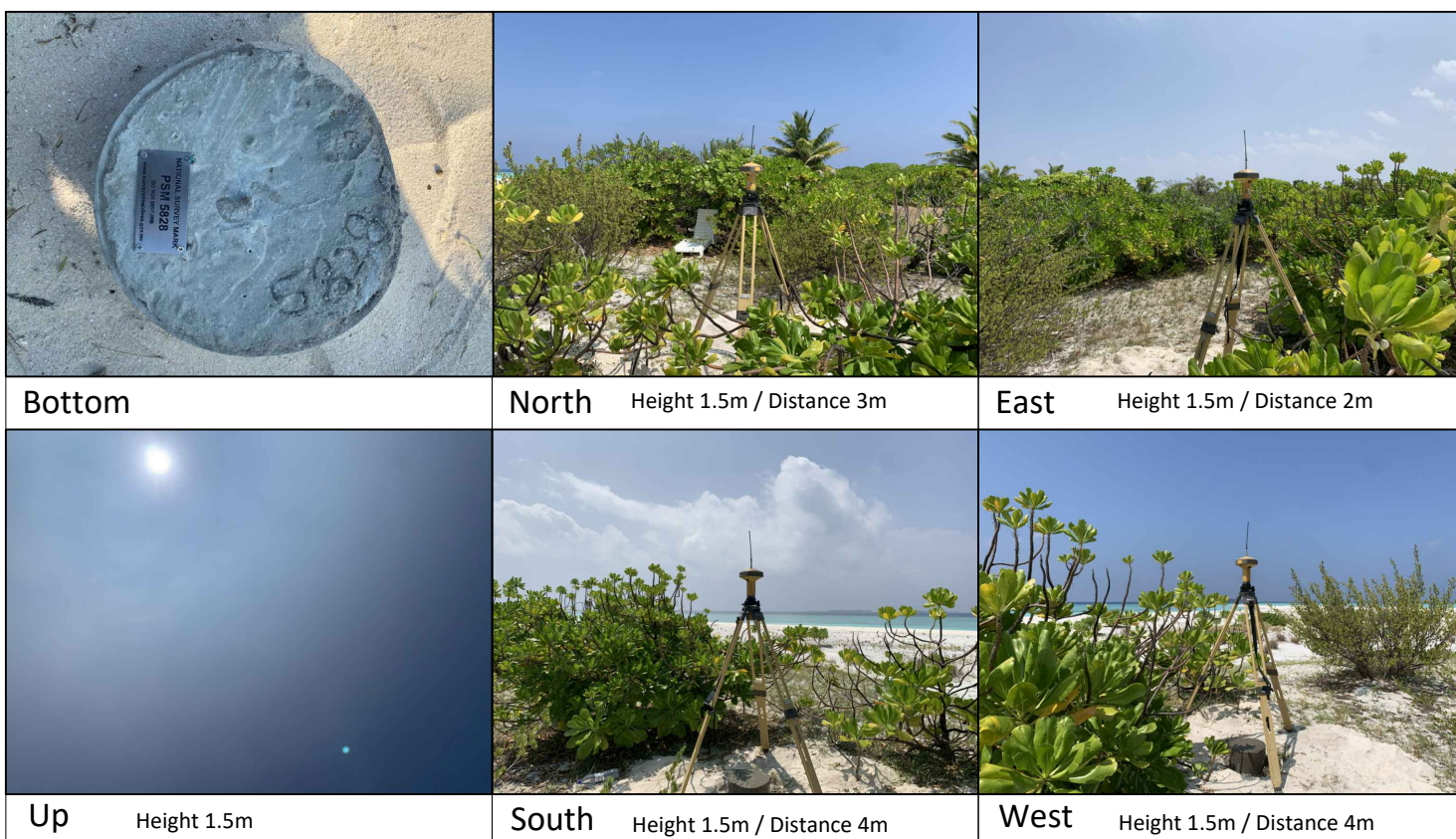

SITE INFORMATION

Station Number

P	S	M	5	8	2	8
---	---	---	---	---	---	---

Station Horizon Mask

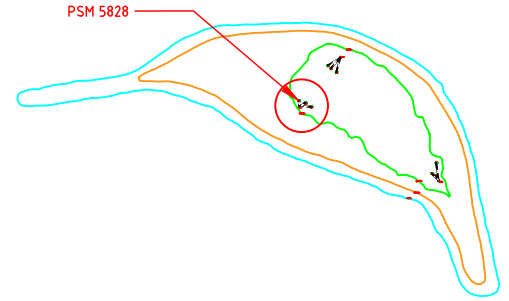
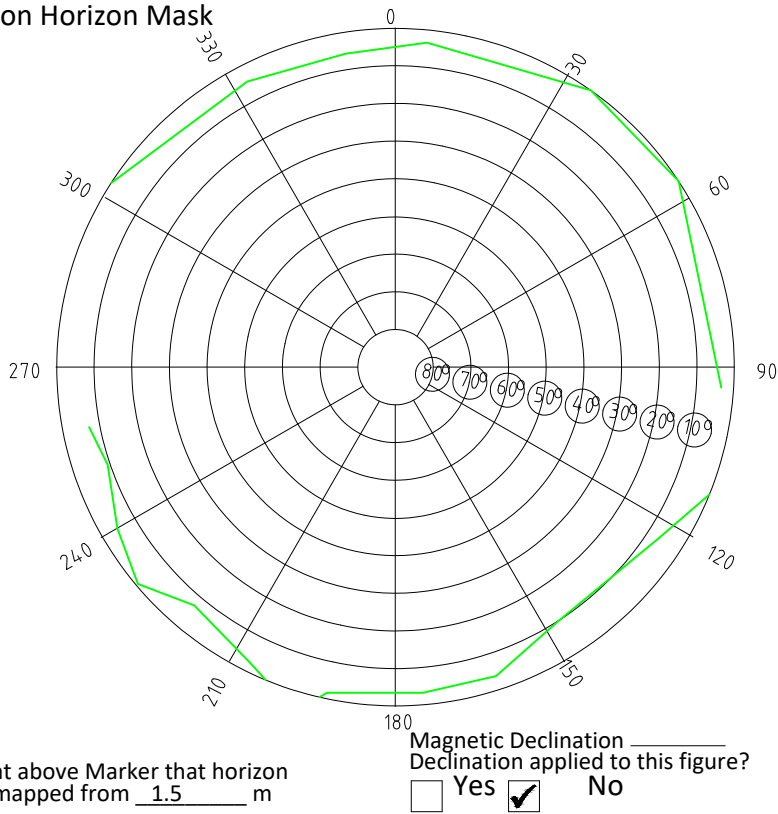

Height above Marker that horizon was mapped from 1.5 m

Magnetic Declination Declination applied to this figure?
 Yes No

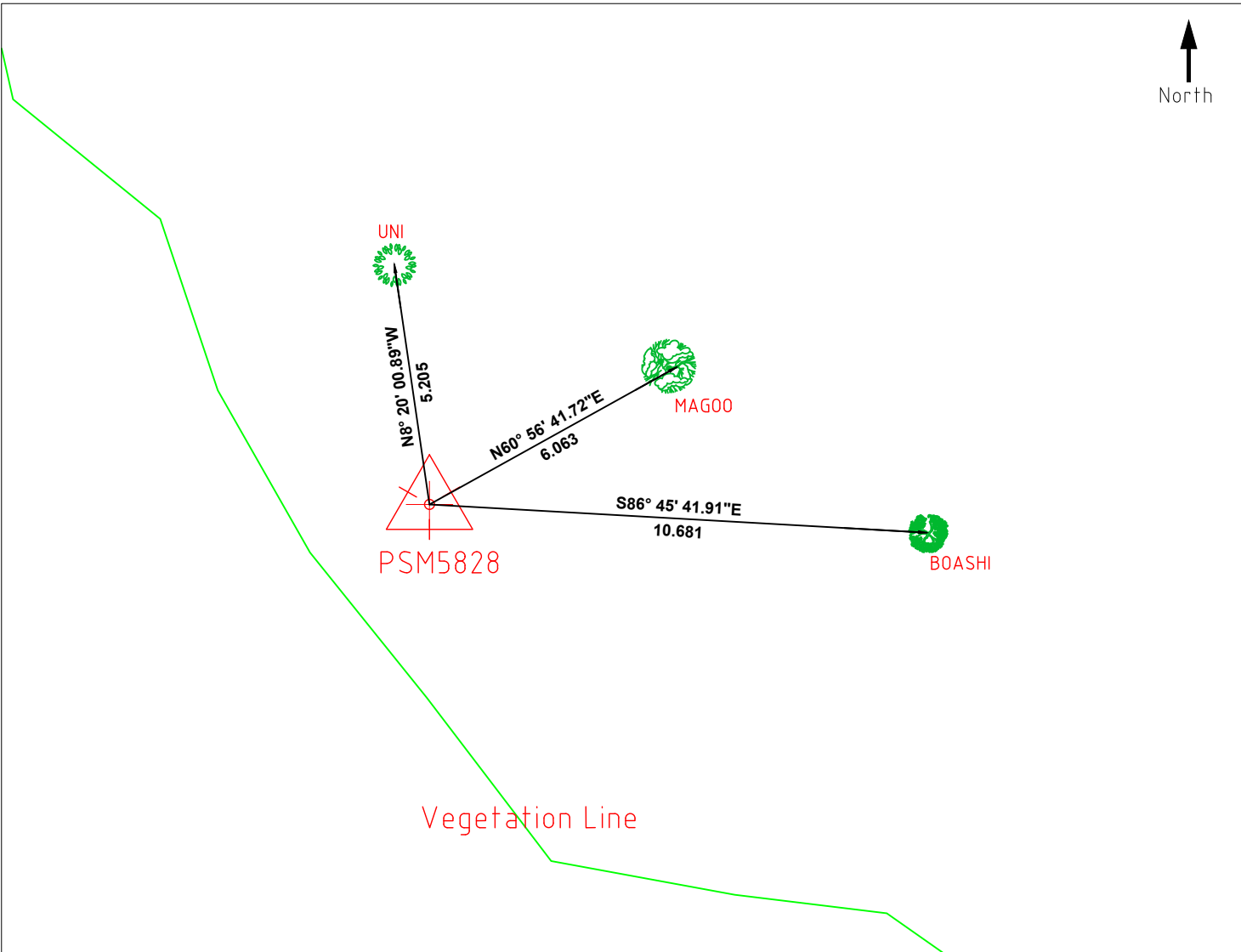

Sketched by: Abulho

Scale: Not to Scale

Date: 16 FEBURARY 2021

MALDIVES LAND SURVEY AUTHORITY

MINISTRY OF HOUSING AND INFRASTRUCTURE
 Office (PABX): +(960) 3004300, Fax: +(960) 3004254
 Email: survey@housing.gov.mv
 Web: www.surveyofmaldives.gov.mv,
 Ameenee Magu, Maafannu, Male', 20392, Maldives.



CONTROL POINT DETAILS	Station Number	PSM 5829
Coordinate Information		
Geodetic	Grid	
WGS 84	UTM Zone 43	
Lat: 5°14'04.41610"N	E:	293814.641 m
Long: 73°08'22.84730"E	N:	578897.765 m
Ellp Height: -106.424	Orth Height:	+1.320m
Island Name: DHIGUDHEFARU (LD0076)	Date: 16 FEBURUARY 2021	

Monument description & method of survey:

- Monument Type A as in Technical Brief
- Stainless steel plate fixed to concrete by Four bolts
- Horizontal coordinates fixed by GNSS Static survey.
- Vertical height corrected using tide prediction data (Hulhule)
- **PSM 5829 is 50mm above ground Level**

General site condition & access:

- Easily accessible area with wide angle of sky visibility
- Located in Southeast side of the island.
- The island has no infrastructure build , only vegetation

Owner: Dhigudhefaru Investments Pvt Ltd.



Bottom	North Height 1.5m / Distance 4m	East Height 1.5m / Distance 4m
Up Height 1.5m	South Height 1.5m / Distance 4m	West Height 1.5m / Distance 4m

SITE INFORMATION

Station Number

P	S	M	5	8	2	9
---	---	---	---	---	---	---

Station Horizon Mask

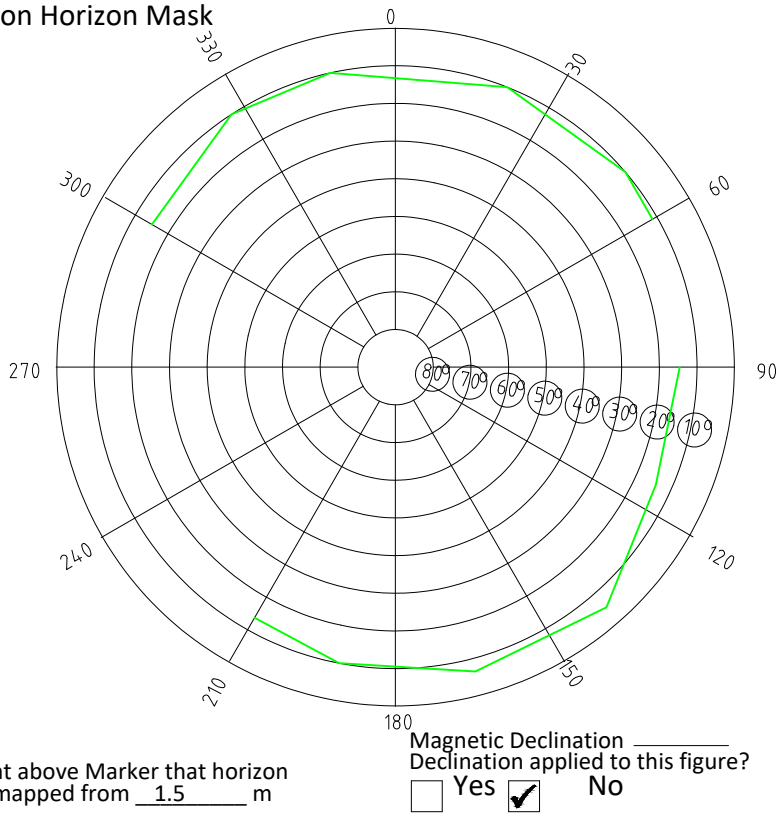

Height above Marker that horizon was mapped from 1.5 m

Magnetic Declination _____
 Declination applied to this figure?
 Yes No

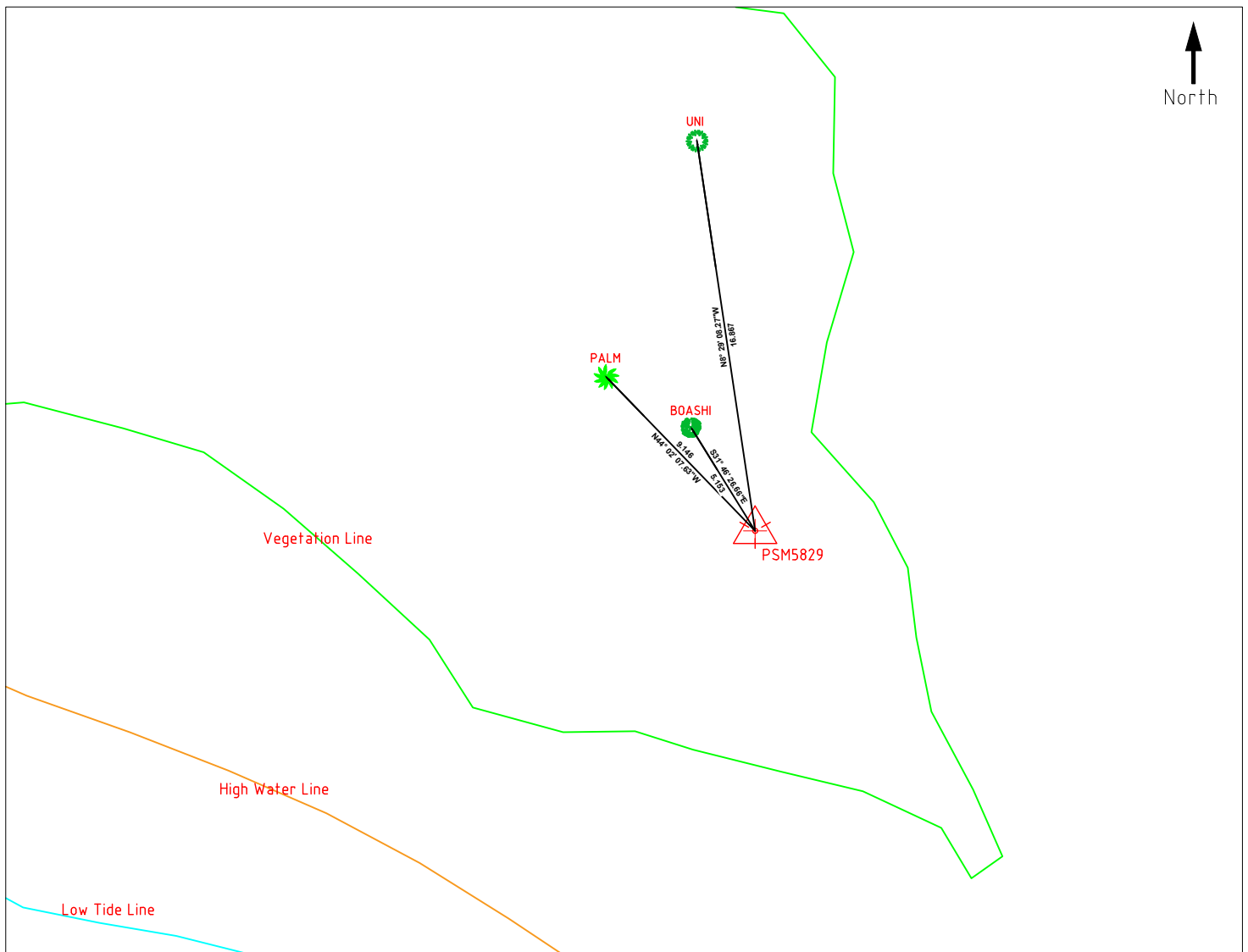
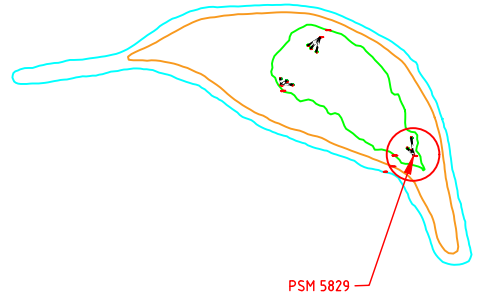

Sketched by: Abulho

Scale: Not to Scale

Date: 16 FEBURARY 2021